

# POBLADO DE EL SALADO

Localización: Sindicatura de El Salado  
Sector 1ro de Mayo, Municipio de Culiacán, Sinaloa.

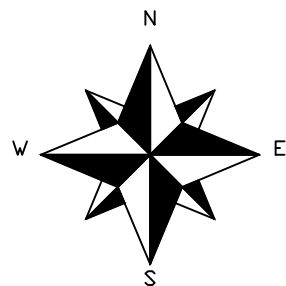
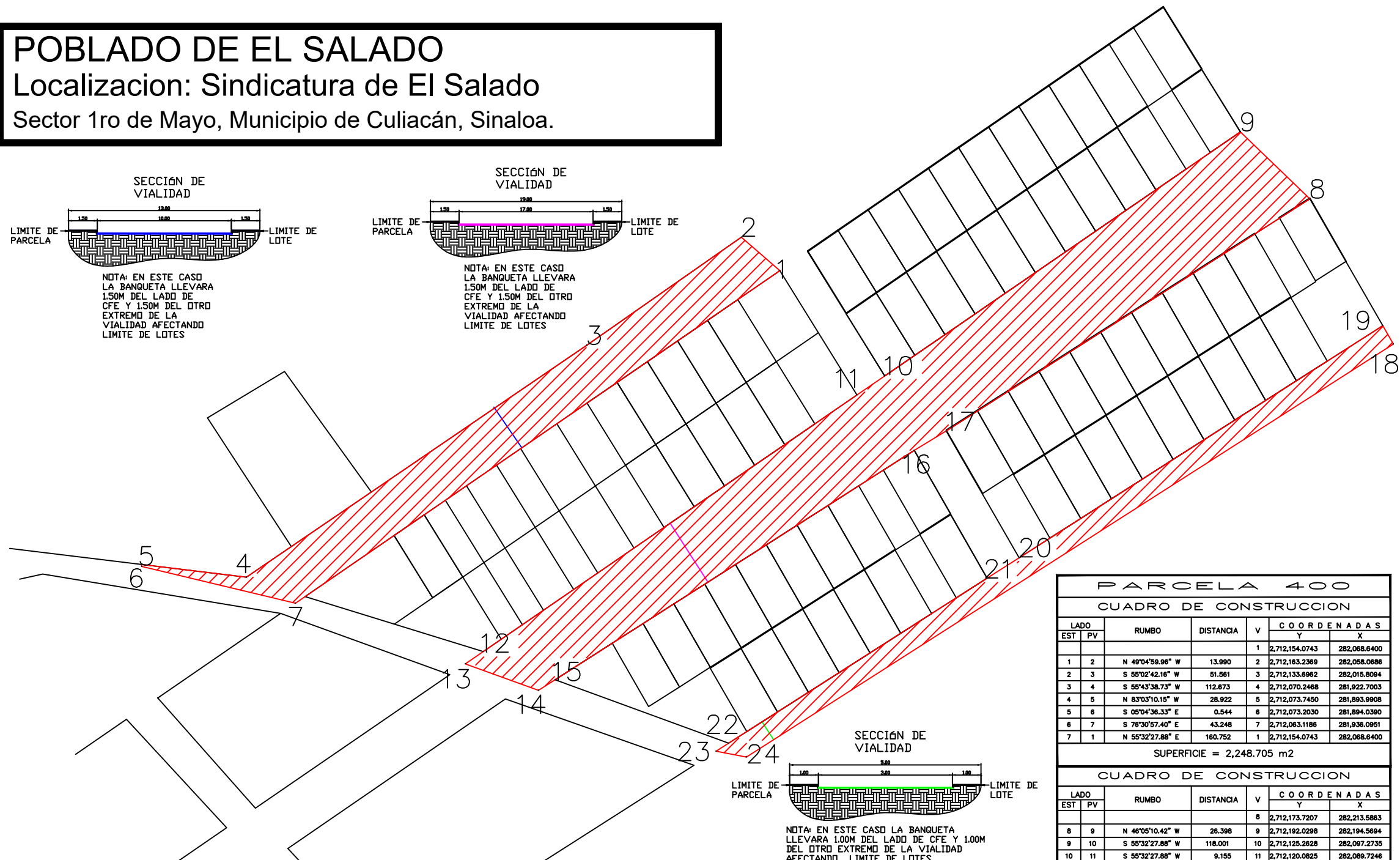
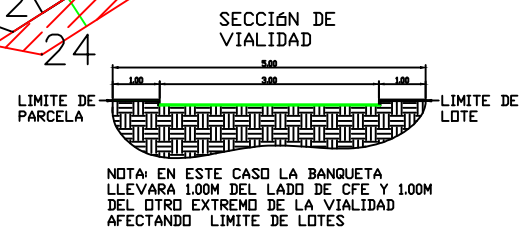
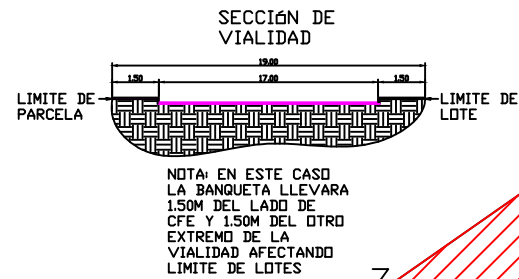
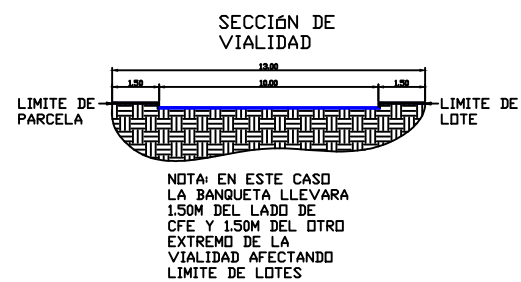

**PARCELA 400**

**CUADRO DE CONSTRUCCION**

LADO EST	PV	RUMBO	DISTANCIA	V	COORDENADAS	
					Y	X
1	2	N 49°04'59.96" W	13.990	2	2,712,154.0743	282,068.6400
2	3	S 55°02'42.16" W	51.561	3	2,712,163.2369	282,058.0686
3	4	S 55°43'38.73" W	112.673	4	2,712,133.6962	282,015.8094
4	5	N 83°03'10.15" W	28.922	5	2,712,070.2468	281,922.7003
5	6	S 05°04'36.33" E	0.544	6	2,712,073.7450	281,893.9908
6	7	S 76°30'57.40" E	43.248	7	2,712,073.2030	281,894.0390
7	1	N 55°32'27.88" E	160.752	1	2,712,063.1186	281,936.0951
					2,712,154.0743	282,068.6400

SUPERFICIE = 2,248.705 m<sup>2</sup>

**CUADRO DE CONSTRUCCION**

LADO EST	PV	RUMBO	DISTANCIA	V	COORDENADAS	
					Y	X
8	9	N 46°05'10.42" W	26.398	8	2,712,173.7207	282,213.5863
9	10	S 55°32'27.88" W	118.001	9	2,712,192.0298	282,194.5694
10	11	S 55°32'27.88" W	9.155	10	2,712,125.2628	282,097.2735
11	12	S 55°32'27.88" W	9.155	11	2,712,120.0625	282,089.7246
12	13	S 55°32'27.88" W	123.971	12	2,712,049.9377	281,967.5063
13	14	S 55°32'27.88" W	5.983	13	2,712,046.5522	281,982.5728
14	15	S 70°07'36.41" E	21.257	14	2,712,039.3282	282,002.5636
15	16	N 57°27'24.23" E	5.381	15	2,712,042.2211	282,007.1001
16	17	N 57°27'24.23" E	116.574	16	2,712,104.9305	282,105.3703
17	18	N 58°42'43.94" E	10.230	17	2,712,110.2435	282,114.1128
18	8	N 57°27'24.23" E	118.001	8	2,712,173.7207	282,213.5863

SUPERFICIE = 5,429.307 m<sup>2</sup>

**CUADRO DE CONSTRUCCION**

LADO EST	PV	RUMBO	DISTANCIA	V	COORDENADAS	
					Y	X
18	19	N 29°53'42.14" W	5.809	18	2,712,134.0071	282,236.4180
19	20	N 29°53'42.14" W	5.809	19	2,712,139.0431	282,233.5228
20	21	S 57°27'24.23" W	118.001	20	2,712,075.5659	282,134.0493
21	22	S 57°27'24.23" W	10.382	21	2,712,069.9812	282,125.2977
22	23	S 57°27'24.23" W	83.855	22	2,712,024.8727	282,054.6094
23	24	S 57°27'24.23" W	4.071	23	2,712,022.8830	282,051.1780
24	18	S 78°58'22.74" E	8.419	24	2,712,021.0727	282,059.4417
					2,712,134.0071	282,236.4180

SUPERFICIE = 1,236.717 m<sup>2</sup>

SUPERFICIE TOTAL = 8,914.729 m<sup>2</sup>



H. AYUNTAMIENTO DE CULIACAN

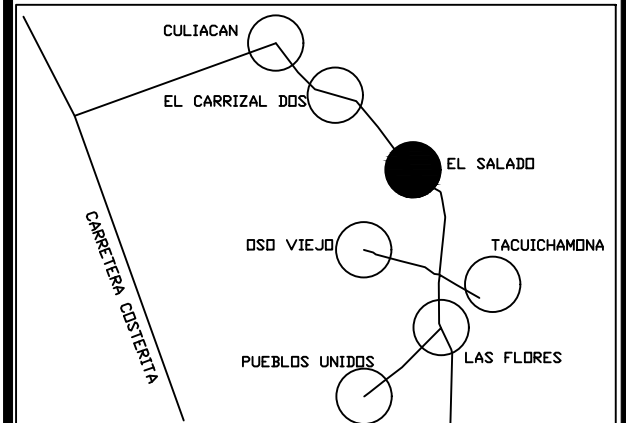

LOCALIZACION

H. AYUNTAMIENTO DE CULIACAN

PLANO PROYECTO:  
AMPLIACION DE RED DE DISTRIBUCION DE ENERGIA ELECTRICA, SECTOR 1RO DE MAYO, EL SALADO, SIND. EL SALADO, MUNICIPIO DE CULIACAN SINALOA.

DIBUJO:  
ING. MARTIN CAMBEROS BUSTAMANTE

PRESIDENTE MUNICIPAL:  
LIC. MIGUEL ANGEL GONZALEZ CERVANTES

SECRETARIA DE DESARROLLO URBANO SUSTENTABLE:  
ING. AURELIANO FELIX DIAZ

DIRECTOR DE OBRAS PUBLICAS:  
C. JAVIER MASCAREÑO QUINÓNEZ

SECRETARIA DE BIENESTAR:  
C. CARLOS ZAMUDIO DE LA HERRAN

CULIACAN, SINALOA.

FECHA: 2021

